

MONDAINE®

Swiss  Watch

/ INSTRUCTION MANUAL /

Solar Collections

Ronda 215 - Time, Date



Since 2020, Mondaine Group (including all brands) is one of the first watch companies worldwide to be comprehensively CO₂ neutral for scope 1,2,3 of the GHG protocol. *Reduce, Reuse, Recycle.*

Swiss Solar Movements Meet Sustainable Precision. How Does It Work?

The **solar movements** capture light through solar cells positioned beneath the watch dial. These cells convert sunlight and artificial light into electrical energy, which is stored in a battery. This stored energy powers the watch, eliminating the need for regular battery replacements and promoting eco-friendly timekeeping. A fully charged battery can power the watch for approximately 8 months without additional exposure to light. To maintain optimal performance, regular charging in direct sunlight is recommended, as it provides the quickest recharge.

Key Features of Solar-Powered Movement

Powered by Light: Solar cells convert sunlight and indoor light into energy, charging a rechargeable battery for eco-friendly timekeeping.

Instant Activation: Two minutes of sunlight are enough to restart a fully discharged movement, ensuring reliability and allowing the movement to run for one day.

Battery Protection: Advanced technology prevents overcharging and deep discharge, ensuring long-lasting performance.

Swiss-Made Excellence: Crafted with precision and quality Swiss RONDA movement, embodying the hallmark of Swiss watchmaking.

Environment	Approximate charging time depending on light source *		
	Day charge	until the movement runs when the battery is empty	until fully charged when the battery is empty
Outdoors (sunny)	2 minutes	1 minute	7 hours
Outdoors (cloudy)	11 minutes	5 minutes	1.5 days
20 cm from a fluorescent lamp (30 W)	35 minutes	20 minutes	5.2 days
Indoor lighting	4.4 hours	2 hours	40 days

Day charge:

Time needed to charge the battery so that the movement runs for one day.

Until the movement runs when the battery is empty:

Time needed to charge the battery to the point where the movement starts running when the battery is discharged.

Until fully charged when the battery is empty:

Time required to fully charge an empty battery.

Time, Date

Time, Date

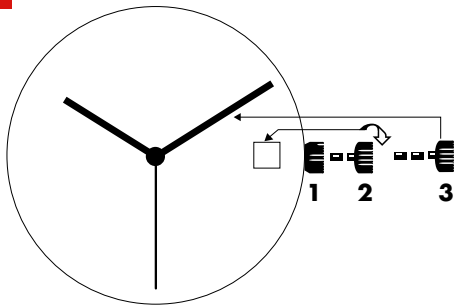

Position 1: Position of rest (watch running)

Position 2: Quick-change correction for date

Pull the crown out to position 2 (watch still running).

Turn the crown clockwise until the required date appears. (Please manually set the date for the following day, as the date will not update automatically at midnight.)

Push the crown back into position 1.

Position 3: Setting the time

Pull the crown out to position 3 (watch stopped).

Turn the crown, until the current time is displayed

Push the crown back into position 1.



WARNING

KEEP THE BATTERY OUT OF REACH OF CHILDREN

The battery can cause serious injuries if swallowed or placed inside any part of the body. Seek medical attention immediately.



GGM.D087
ED. 06/25



Registered models. All rights reserved and defended by the manufacturer and the Swiss Government authorities. All wrist watches are Swiss made by  Mondaine Watch Ltd, Etzelstrasse 27, 8808 Pfäffikon, Switzerland
T +41 (0)58 666 88 00 | info@mondaine.ch

www.mondaine.ch